

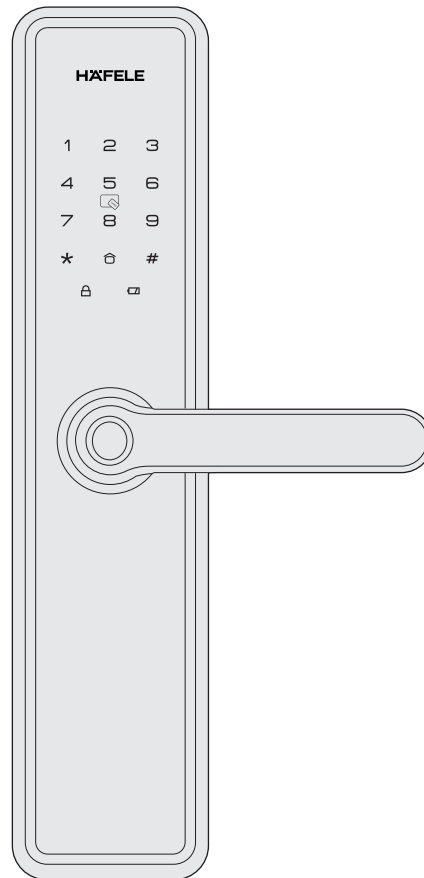

Digital door lock
Model DL7600



DL7600
User manual

Contents

Read before using

Product features	2
Warnings	3
Product specifications	3
Factory default settings	4
Quick setup guide	4

Lock operation

How to change master PIN code	5
How to add user PIN code	5
How to add fingerprint	5
How to add key card	6
How to delete user PIN code	6
How to delete fingerprint	6
How to delete key card	7
Opening mode setting	7
Voice guide setting	7
Language setting	8
System query serial number	8
Network module (Optionally available)	8
Bluetooth setting	9
Defense mode	9
Auto/Manual mode	9
Privacy mode	10
Safe handle switch	10
Mute/Voice switch (Temporary setting)	10
Menu table	11

How to use

How to open the door	12
How to open the door from inside	12
How to lock the door	13
Restore to factory setting	13
Micro USB emergency power supply...13	
Reboot button.....14	
Replace batteries.....14	
Network module.....14	

Read before using

✓ Product features



5 way solution

Five electronic locking modes: master PIN code/user PIN code, key card, fingerprint, App and emergency key.



Master PIN code/ User PIN code/ Key card/ and Fingerprint identification

1 master PIN code, up to 10 user PIN codes, 100 key cards, 100 fingerprints.



Random security coding function

The random number can be added before or after the real user PIN code but the maximum length is 32 digits. This feature will prevent the real user PIN code from being exposed.



Auto lock / Auto re-lock function

When the door is closed, the lock will lock automatically (In case of auto locking mode).



Privacy function

When the privacy function is activated the door cannot be opened from outside with user PIN code, key card or fingerprint except with master PIN code.



Defense mode

If someone break in and exit from inside, the lock will alarm.



Burglary alarm function

When the door is opened by force, the lock is suspended with alarm.



Prevent mischief and hacking

When entering 5 times a wrong user PIN code, key card and fingerprint, the lock is suspended 2 minutes. After that the lock will activate again. While the lock is suspended, the system will alarm when you are trying to use keypad.



Alarm for battery replacement time

When the power of battery is too low, a warning voice will appear. Please replace all batteries immediately.

Read before using

Warnings

- * Read and understand all instructions before use.
- * If damage is caused by failure to follow this instructions, the warranty does not apply.
- * Only use the alkaline batteries.
- * Do not expose the product and accessories to rain or water.
- * Do not expose the product to corrosive substances to avoid damage to the protective cover.
- * Do not scrape the fingerprint sensor with any sharp objects, otherwise it may cause permanent damage.
- * When cleaning the product, please wipe with a soft cloth.
- * If there is a low battery alert, please replace all the batteries in time and make sure they are properly installed.

Product specifications

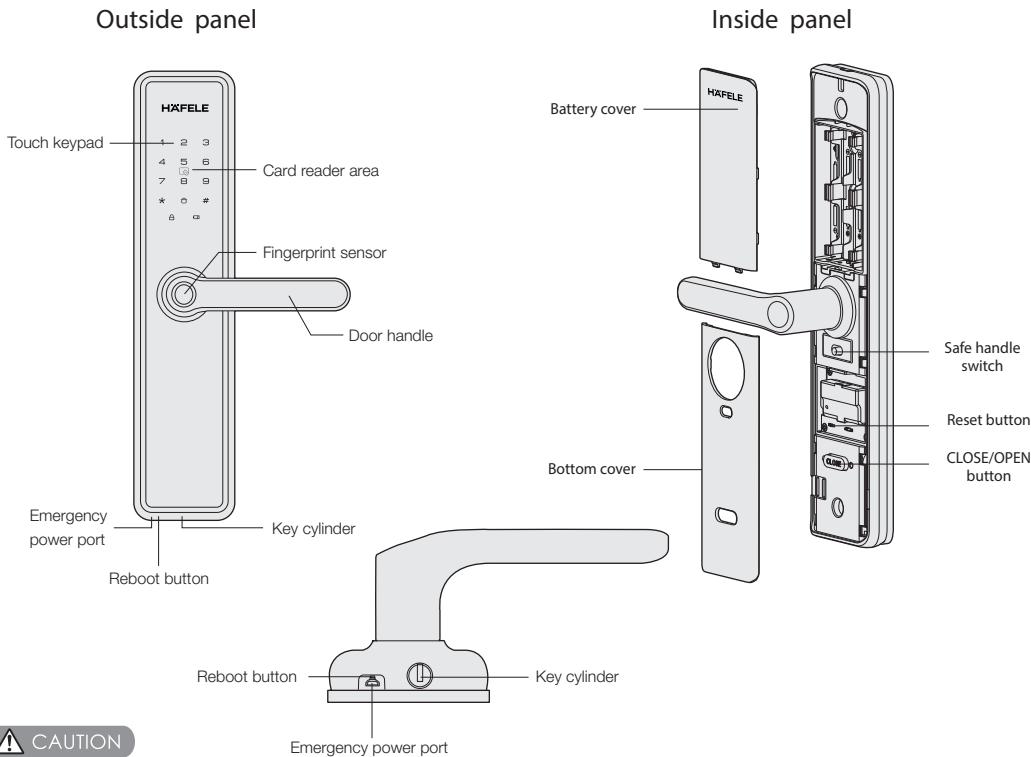

CAUTION

1. You can follow the voice guide by multi-language (English/Chinese).
2. Master PIN code (6-12 digits): Default master PIN code is "12345678", please modify it after installation.
3. User PIN code (6-12 digits): Maximum capacity is 10 with user number [00-09].
4. Fingerprint: Maximum capacity is 100 with user number [00-99].
5. Card: Maximum capacity is 100 with user number [00-99].

Read before using

✓ Factory default settings

Settings	Factory defaults
Master PIN code*	12345678
Opening mode setting	Normal mode
Speaker	Enabled
Wrong code entry limit	5 times
Shutdown time	2 mins
Voice guide language	English

*Important: First step is to set your own master PIN code.

✓ Quick setup guide

MP

Master PIN code

UP

User PIN code

**00~
09**

Input number (00~09)

**00~
99**

Input number (00~99)



Enter fingerprint



Enter card



Star key, return to previous menu



Touch the screen to activate lock

Lock operation

✓ Add/Change access data

How to change master PIN code

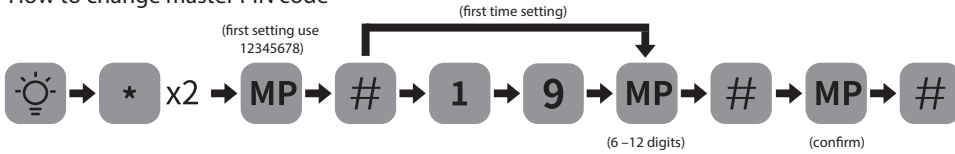

⚠ CAUTION

1. Before changing default master PIN code, all other setting menu will be disabled. You have to change master PIN code first, then do other lock settings.

How to add user PIN codes

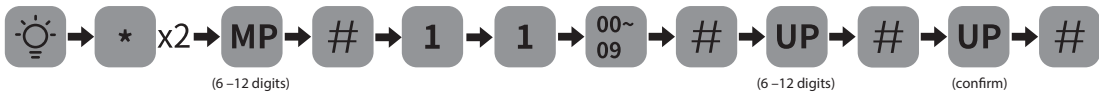

User Number	User Type	Notes
00-04	Normal User	* Permanent
05-08	Temporary User	* Invalid after using one time or in safety mode
09	Reserved	* Only used in combination with network Module expansion

⚠ CAUTION

1. When registering user PIN codes, the code must be entered within 10 seconds.
2. At any time you can return to the previous menu by pressing the “ * ” key.

How to add fingerprints

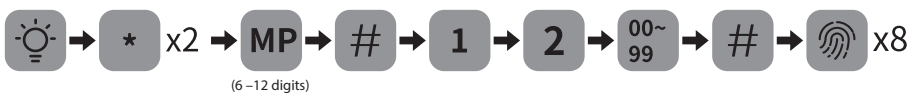

User Number	User Type	Notes
00-94	Normal User	* Permanent
95-99	Reserved	* Only used in combination with network Module expansion

⚠ CAUTION

1. When registering user fingerprint, the fingerprint must be entered within 10 seconds.
2. At any time you can return to the previous menu by pressing the “ * ” key.

Lock operation

✓ Add/Change access data

How to add key cards

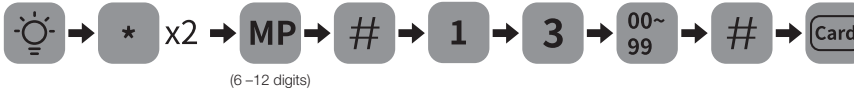

⚠ CAUTION

1. When registering user card, the card must be entered within 10 seconds.
2. At any time you can return to the previous menu by pressing the "*" key.

✓ Delete access data

How to delete user PIN code

Delete one user PIN code

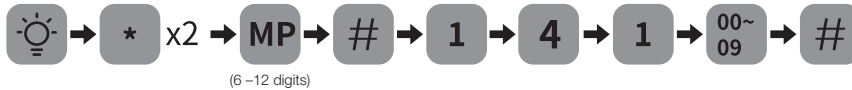

Delete all user PIN code (Unusable in safe mode)



⚠ CAUTION

1. When deleting user PIN codes, the user number must be entered within 10 seconds.
2. At any time you can return to the previous menu by pressing the "*" key.

How to delete user fingerprint

Delete one user fingerprint



Delete all user fingerprints (Unusable in safe mode)



⚠ CAUTION

1. When deleting user fingerprint, the fingerprint or user number must be entered within 10 seconds.
2. At any time you can return to the previous menu by pressing the "*" key.

Lock operation

✓ Delete access data

How to delete key card

Delete one key card



Delete all key cards (Unusable in safe mode)



⚠ CAUTION

1. When deleting key card, the card or user number must be entered within 10 seconds.
2. At any time you can return to the previous menu by pressing the "*" key.

Opening mode setting

Normal mode: Single verification means opening by PIN code or fingerprint or card.



Safe mode: Double verification means opening by PIN code + fingerprint or PIN code + card or fingerprint + card.



Voice guide setting

Turn on voice guide



Turn off voice guide (Excluding alarm and menu operation)



Lock operation

✓ Additional lock features

Language setting

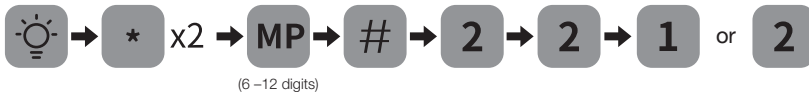

1 Chinese

2 English

System query serial number



Network module (Optionally available)

Join network



Log off network



Lock operation

Additional lock features

Bluetooth settings

Enable Bluetooth

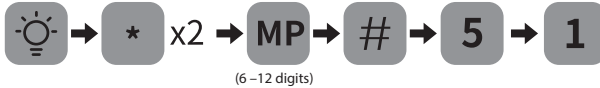

Manage Bluetooth (under Bluetooth turned on)

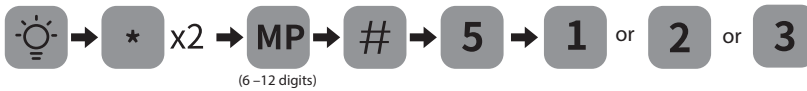

- 1** Connect Bluetooth **2** Disconnect Bluetooth **3** Disable Bluetooth

CAUTION

1. The default setting for Bluetooth is disabled.
2. Please enabling the Bluetooth first, before you manage Bluetooth. And please keep it is turned on, when you use it.

Defense mode

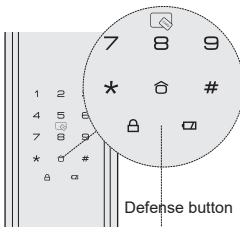

1. Enable: After door is locked, press [🔒] button to enable defense mode. Voice prompt “Outside forced lock enabled”. In this mode, when the door is unlocked from inside, the alarm will be triggered.
2. Disable: Once the door is opened properly from outside, the defense mode will be disabled.

Auto/Manual mode

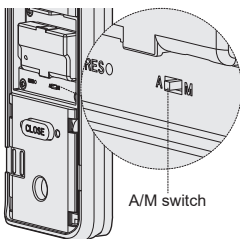

1. Remove button cover to find the A/M switch.
2. [A] means auto mode: when door is closed, the deadbolt will drive out automatically, the door will be in locked status.
3. [M] means manual mode: when door is closed, the deadbolt will not driven out, then the door will be in unlocked status.

CAUTION

In manual mode, when the door is closed, please verify user fingerprint/Pin code/card to lock the door from outside or press the [CLOSE] button on the back panel to lock from inside

Lock operation

✓ Additional lock features

Privacy mode

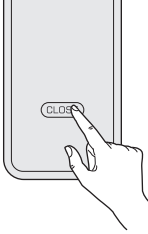

When door is locked, long press [CLOSE] button to switch on privacy mode. Voice prompt “Inside deadlock enabled”, only Master PIN code and mechanical key can open the door from outside. User PIN code/ Fingerprint/Card is prohibited.

Safe handle feature

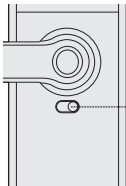

Safe handle switch

1. Enable: Move the safe handle switch to display “red” mark. Once safe handle feature is enabled, the indoor handle will be locked.
2. Disable: Move the safe handle switch to display “green” mark. The indoor handle can be pressed down freely.

Mute/Voice switch (Temporary setting)

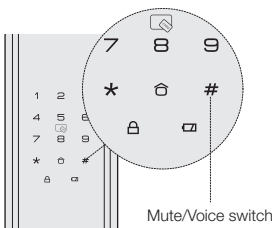

Voice> Mute: When default setting is voice mode, long press [#] button to enable mute mode. After the lock wake up from sleeping status, mute mode will be disabled automatically.
Mute> Voice: When default setting is mute mode, long press [#] button to enable voice mode. After the lock wake up from sleeping status, voice mode will be disabled automatically.

✓ Menu table

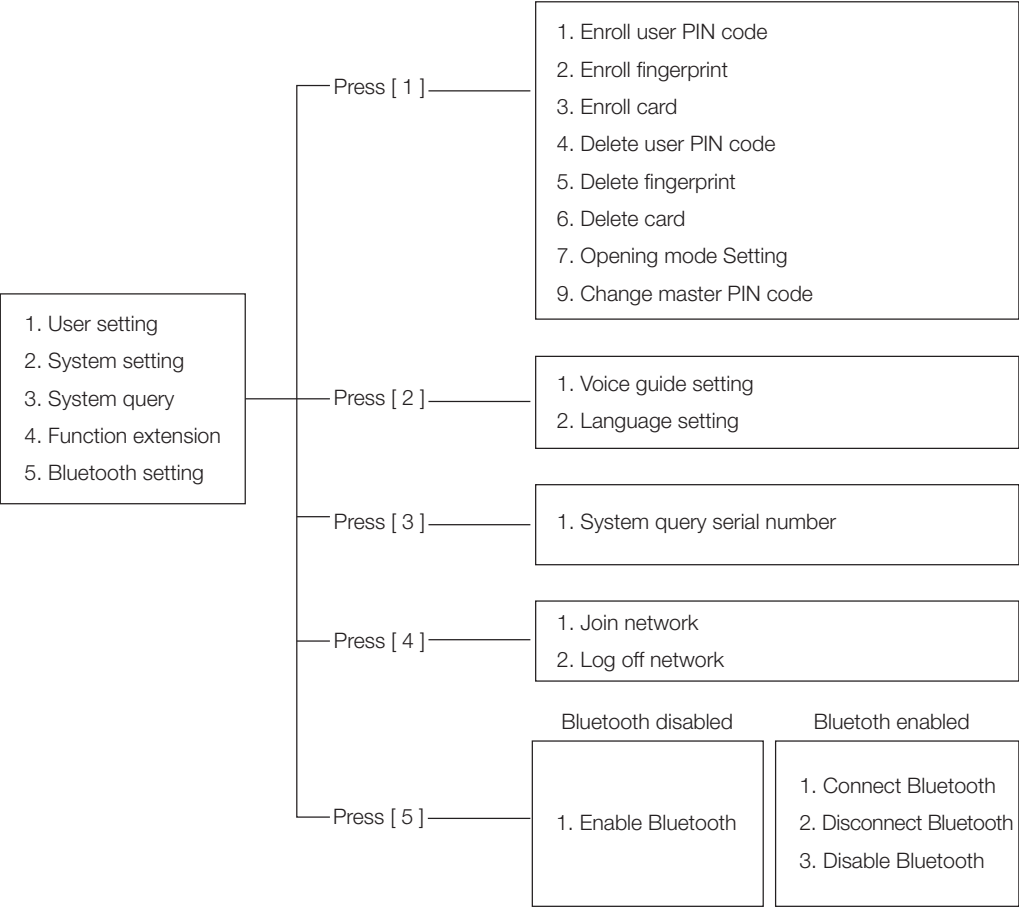

How to use

✓ Open & Lock the door

How to open the door from outside

PIN code

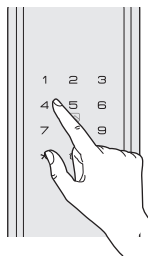

1. Touch keypad by palm to lighten keypad.
2. Enter the enrolled PIN code with end of [#]. Voice prompt "Verification Succeeded".
3. Press down the handle to open the door.

Fingerprint

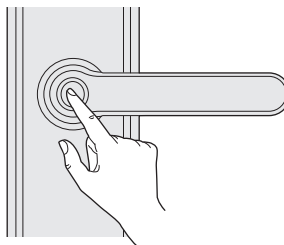

1. Place the enrolled finger properly on the fingerprint sensor area until one beep sound and voice prompt "Verification Succeeded".
2. Press down the handle to open the door.

Card

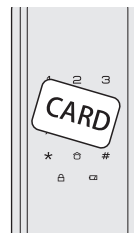

1. Place the enrolled card properly on the card icon area until one beep sound and voice prompt "Verification Succeeded".
2. Press down the handle to open the door.

Random security coding function

The random number can be added before or after the real user PIN code but the maximum length is 32 digits. This feature will prevent the real user PIN code from being exposed.

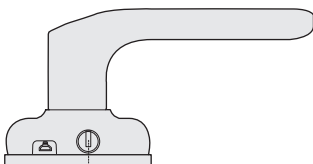

Mechanical key

Mechanical key

Insert the key into key hole and rotate it with proper angles. Then press down handle to open the door.

How to open the door from inside

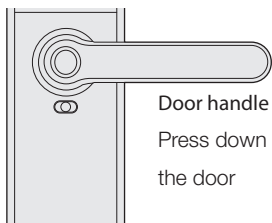

Door handle

Press down the handle to open the door

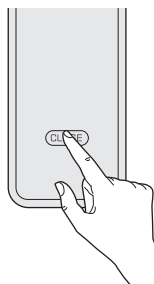

CLOSE/OPEN button

Press [CLOSE] button 2 times to open.

How to use

✓ Open & Lock the door

How to lock the door

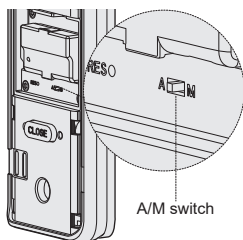

Auto locking

In auto mode, door will be locked automatically in 1.5 seconds after closing.

Manual locking

In manual mode, press [CLOSE] button to lock the door from inside or verify user fingerprint/PIN code/card to lock the door from outside.

✓ Service features

Restore to factory default settings

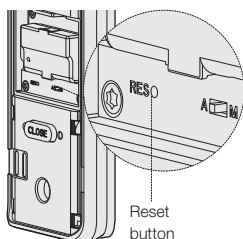

Operation instructions:

1. Open button cover and find the reset button.
2. Use a paper clip to double click [RES] button, then voice prompt "Restored to factory settings. Change master PIN code."
3. After that all user data and settings will be deleted.

Micro USB emergency power supply

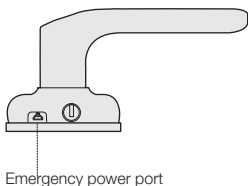

When the battery voltage is too low and cannot be opened from outside, connect a 5V power supply via Micro USB port at the front. Then unlock the door and replace all batteries immediately.

How to use

✓ Service features

Reboot button

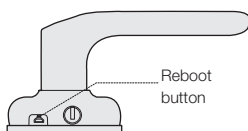

Press the reboot button to restart the lock when the system is unresponsive, no user data is deleted.

Replace batteries

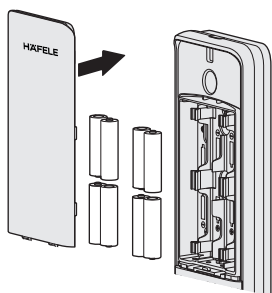

1.5V AA Alkaline Battery is required. Total is 8 pcs, divided into 2 groups.

One group is ok for power supply, two groups is used for longer time.

⚠ CAUTION Do not mix old and new batteries together in replacement.

Network module

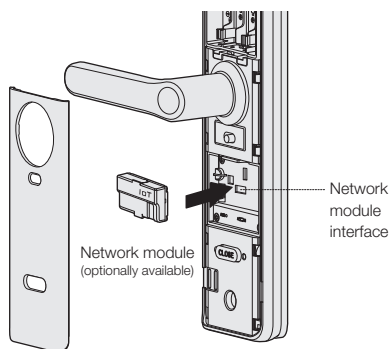

Access into master mode and press [4] for function extension, which is reserved for wireless communication and other smart home interface.

Please contact Hafele customer service center for more details.