

HÄFELE

BUILT-IN HOB (HOUSEHOLD USE)

INSTRUCTIONS

FOR USER & MAINTENANCE

ISO9001:2008



PLEASE READ USER'S MANUAL CAREFULLY BEFORE INSTALLATION AND OPERATION

CONTENT

INSTRUCTIONS FOR INSTALLER

1. Warning-----	1
2. Introducing-----	1
3. Technical data-----	2
4. Instructions for Installation-----	2
5. The switch of the gas-----	5

INSTRUCTIONS FOR USER

1. Warning -----	6
2. Use of the appliance -----	6
3. Cleaning and maintenance -----	7

INSTRUCTIONS FOR INSTALLER

We thank you and congratulate you on your choice. This carefully designed product, manufactured with the highest quality tested to satisfy all your cooking demands. We would therefore request you to read and follow these easy instructions which will allow you to obtain excellent results right from the start.

Warning:

- Prior to installation, ensure that the local distribution conditions (N.G. or LPG and gas pressure) and the adjustment of the appliance are compatible.
- The adjustment conditions for this appliance are stated on the label (or data plate).
- This appliance is not connected to a combustion products evacuation device. It shall be installed and connected in accordance with current installation regulations. Particular attention shall be given to the relevant requirements regarding ventilation.
- The gas hose should not touch objects with sharp edges.
- Always unplug the appliance from the mains before installing and maintenance.

Introducing

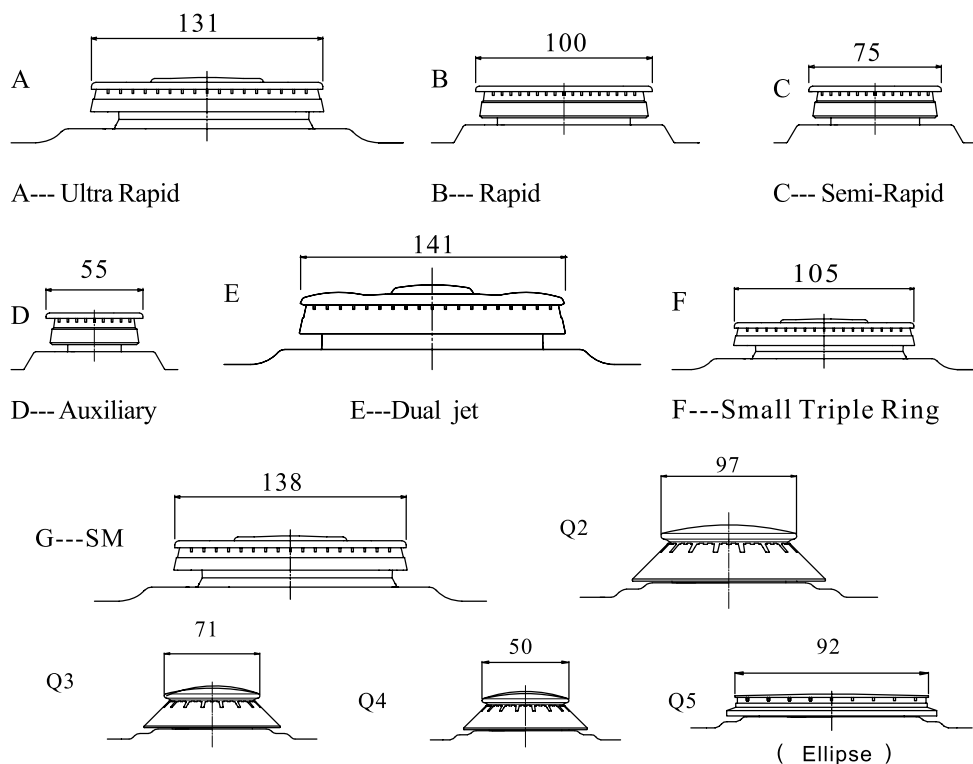

How to clean the stainless steel surface

These parts should be clean with special detergents, and dry any water drops. Attention: clean it carefully to avoid any fray or scratch of the surface. It's recommended to clean stainless steel with soft cloth and neutral detergents, never use non-neutral ones such as abrasive or acid detergents. Otherwise, the finish of the stainless steel will be damaged severely.

Caution:

- This appliance is not intended for use by persons (including children) with reduced physical, sensory or mental capabilities, or lack of experience and knowledge, unless they have been given supervision or instruction concerning use of the appliance by a person responsible for their safety.
- Children should be supervised to ensure that they do not play with the appliance.
- This appliance is for household use only. It is only used to remove dust indoors but not applied for industrial or coasting areas.
- If the supply cord is damaged, it must be replaced by the manufacturer or its service agent or a similarly qualified person in order to avoid a hazard.
- The appliance is intended to be used in household only.
- Do not immerse appliance or power cord into water or any other liquids for cleaning.

7, Correct Disposal of this product:

This marking indicates that this products should not be disposed with other household wastes throughout the EU. To prevent possible harm to the environment or human health from uncontrolled waste disposal, recycle it responsibly to promote the sustainable reuse of material resources. To return your used device, please use the return and collection systems or contact the retailer where the product was purchased. They can take this product for environmental safe recycling.



Rotate the knob towards the position required for cooking and bear in mind that the higher the number, the higher the heat output. See table "use of electrical plates" heating elements vitroc ceramic.

The pilot light signals that the plate is "on"

When using electrical plates/heating elements vitroc ceramic, we recommend flat bottom recipients with a diameter equal or slightly larger than that of the plate itself.

-avoid liquid overflow. Therefore, after boiling or heating liquids, reduce the heat output;

-do not leave the electrical plates on with empty pots and pans;

-when cooking is finished, rotate the knob back into closing and/or disconnected position.

Attention:

1, Don't touch the appliance with waterish hand or foot.

2, Don't use the appliance when without dressing shoes.

3, Don't let children or incompetence person operate the appliance.

4, Cut off the electric before cleaning or maintenance the appliance.

5, Never try to remove a plug from the mains supply socket by pulling the cable.

6, When the appliance is on work, the temperature of the hotplate and around surface will be high. Don't touch it and make sure the children remoteness.

7, If the appliance break down and/or does not work properly, switch off and do not tamper it. All repairs (including damage of mains supply) should be operated by an approved service agent, and you should insist that only original spare parts are used.

First using:

During the first use, fume and odours may occur which is normal.

In the event of even a slight fracture on the cooking vitroc ceramic

surface, disconnect the electric power supply immediately.

The appliance becomes hot during use. Take care not to touch the heating elements

How to use the appliance

When finish installation, please connect the powerline plug to the socket with earthing device. Electrical plate is a constant temperature heating device, electrical plate works with a constant temperature. When rotate the knob to position 1-3 or 1-6 by clockwise, the electrical plate works and the indicator on. When the electrical plate heat up to a setting temperature, the indicator off and the electrical plate keep in a constant temperature. When the temperature lower than setting temperature. The electrical plate heat again and indicator on. The electrical plate works like this. So the electrical plate works in a constant temperature. The higher the number of the indicator position, the higher the temperature. When the electrical plate does not need to work more, please turn the knob to 0 position. Then the electrical plate stop work. But the electrical plate still very hot. Please take care not to touch the electrical plate.

TECHNICAL DATA

Burner	Type of gas	Nozzle diameter	Nominal Charge			Reduced Charge	Diameter by-pass 1/100mm
		1/100mm	g/h	L/h	kW	kW	
A	NaturalG20	135		314	3.3	1.75	100
	ButaneG30	91	220		3.0	1.6	70
B Q2	NaturalG20	120		238	2.8	1.5	90
	ButaneG30	75	154		2.1	1.1	50
C Q3 Q5	NaturalG20	97		152	1.75	0.85	70
	ButaneG30	60	110		1.5	0.55	45
D Q4	NaturalG20	80		95	1.1	0.6	60
	ButaneG30	48	66		0.9	0.5	35
E	NaturalG20	100×2, 66×1		345	3.6	0.5	100
	ButaneG30	65×2, 40×1	256		3.5	0.5	70
F	NaturalG20	122		221	2.6	1.5	90
	ButaneG30	80	154		2.1	1.1	50
G	NaturalG20	92×2, 55×1		343	3.6	1.91	100
	ButaneG30	63×2, 40×1	240		3.6	1.75	70

Gas inlet connection: G1/2" (G3/8" G1/4")

INSTRUCTIONS FOR INSTALLATION

- 1) Do not put the combustible and explosive materials close to the appliance
- 2) The installation and maintenance should be carried out by the qualified installation companies, or installation agents, or the gas suppliers.
- 3) The mains socket connecting with the gas hob must be accord with the local relevant regulations, and be correctly and efficiently earthed.
- 4) The type of gas and the pressure must be accord with the specifications indicated on the data plate of the gas hob.
- 5) The gas hose, mental tub or the gas valve connecting with gas inlet must be compliance with the national safety requirements.
- 6) The gas hob must be built-in the cabinet which must resist to 80C higher than ambient temperature and can resist to over 30kg pressure.
- 7) The manufacturer declines all responsibility for damage resulting from incorrect earthed, incompliance with electrical regulations and national safety requirements.
- 8) The hob is not equipped with exhaust, therefore the hob must be installed and operate in permanently well-ventilated places according to local regulations in force.

Drill the hole on the cook-top as dimension of templet in the package. The hole size, minimum distance to the adjacent wall, minimum clearance under the hob base, and minimum distance above the hob must be in compliance with requirements showed on (Take figure 1 as a example).
If you want to install the sponge and the fixture pls check how to do first as figure 2

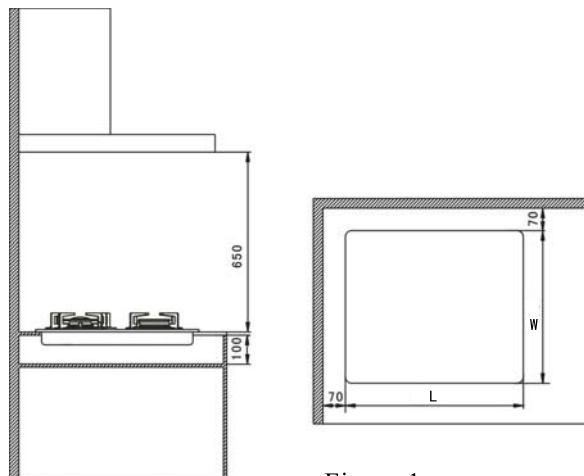

Figure 1

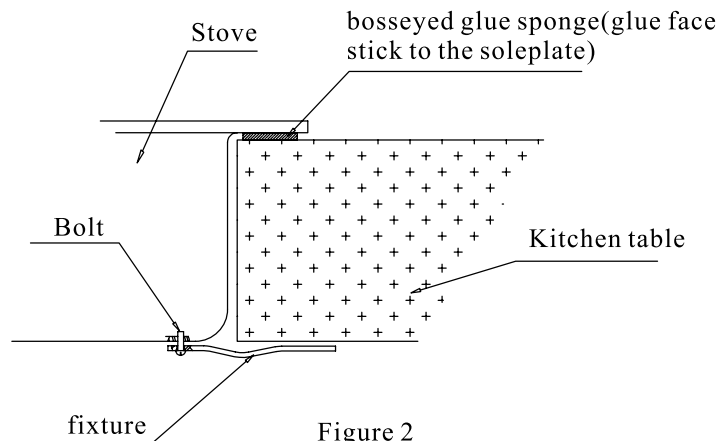

Figure 2

1. Install sponge: stick the sponge's glue face to the soleplate edge to be circuit
2. Install fixture: put the stove into the stove hole on the kitchen table. put the bolt through the fixture and screw to the corresponding hole in the soleplate

Cleaning of Burners

Remove the burner from the hob for cleaning with soapy solutions, it's best to use the soft cloth which used for the silver cleaning.

During or after cleaning, make sure to keep the burner lid and the burner dry, and put them in the corresponding positions.

It is very important to check the right position of the burner lid, as the wrong position may result in serious damage.

Attention:

Do not ignite the burners when they out of place to avoid damage of electronic ignition device.

Not use cooking vessels on the hotplate that overlapis edges.

Not incorrect use of this appliance.

How to remove the burner correctly

It is very important to check the burner cup "F" and the burner lid "C" are in the right position or not. Since any ignorance may cause serious damage. Regularly check the ignition pin "S" and keep it clean to guarantee easy ignition. (Figure 3)

The Triple Ring Burner

The triple ring burner also should be in the right place, position it as showed in (Figure 4).

Once the position of the burner is fixed, do not revolve it any more.

Put the burner lids "A" and "B" on them when the position is fixed (Figure 5)

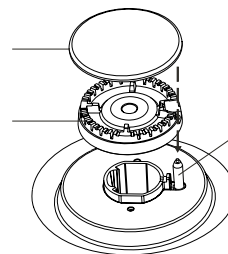

Figure 3

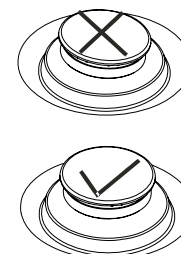

Figure 4

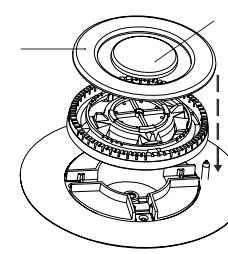
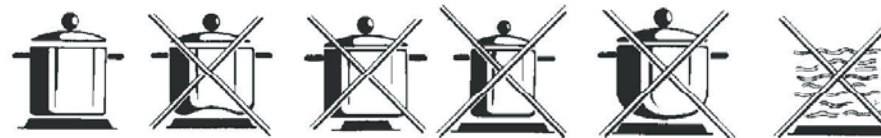

Figure 5

If with Electrical plates/Vitroceramic heating elements(Fig.8)



- 2) When failure ignition, repeat the above process in 1 minute and make sure all ignition process should be completed within 15 seconds.
- 3) When cooking is finished, press and rotate the knob in the clockwise direction to the marker "●". And close gas supply.
- 4) On the control panel of the cook top, there are figures to show each knob for corresponding burner. Select the suitable burner according to required energy of cooking. The data listed in the following table is for your reference.

Corresponding burner	the minimum diameter	the maximum diameter
F	140mm	240mm
E	260mm	280mm
D	120mm	140mm
C	160mm	180mm
B	240mm	260mm
A G	260mm	280mm
Q2	95mm	280mm
Q3	85mm	260mm
Q4	55mm	120mm
Q5	140mm	200mm
Do not use the pans with concavo-convex		

When you smell the gas leakage:

- . Cut off the gas supply immediately
- . Open the window immediately
- . Never use a flame
- . Do not use the appliance
- . Do not use the electric switch and do not turn the light on
- . Make a call to the gas supplier immediately at outside.
- . Make repair in compliance with the gas supplier's instruction or ask for a qualified technical person to do it.

Cleaning and maintenance

Prior to cleaning or maintenance, disconnect it from the electric power supply and make sure the appliance is cool.

Regularly check if the pipe is on a good state, no abrasion or broken.

Do not use steam equipment to clean the appliance, as the steam will get in to the appliance, which can result in danger.

GAS CONNECTION

1. The gas connection must be carried out by a qualified technician according to standard regulations.
2. Rubber hose or flexible metal pipe which is easy to inspect and in compliance with national safety requirements should be used for gas connection.
3. When rubber tube is used, fix rubber clamping loop on it and connect it with the tie-in at the bottom of the hob, then insert a tightening loop with 20mm length. The tube should not be less than 1.5m, and the loop must be in compliance with safety requirements.
4. When mental tube is used to connect with gas supply, which length should not exceed 2m. The pipe and the washer should be accord with the national safety requirements. Unscrew the rubber tie-in at the bottom of the hob with a wrench, instead, screw down a special metal pipe complying with local regulations at gas inlet opening of the hob. The washer is the key to make sure the airproof of gas connection. Immediate renew is recommended even minor transformation or damage is found.
The flexible tube shall be fitted in such a way that it cannot come into contact with a moveable part of the housing unit and does not pass through any space susceptible of becoming congested.
5. When gas connection has been completed, check the eventual leaks with soapy solution, never use a flame.
6. Original spare parts from manufacturer are recommended to use concerning installation and maintenance, otherwise, the manufacturer declines responsibility for any damage.
7. Regular lubricating, maintaining and servicing should be carried out by a qualified technician.

CHECK THE SEAL.

Once the appliances has been installed make sure all the connections are properly sealed especially sealing of the connection joints (gasket)is fit in gas connector. Using a soapy water solution to check after complete installation

Note: Failure to ensure the complete fitting of the parts can lead to injury and property damage.

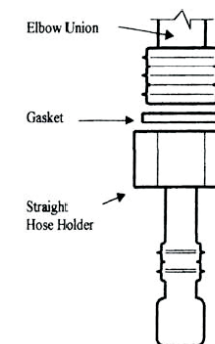

6. There is easy access to the socket and the omnipolar circuit breaker, once the hob has been installed.
7. If the mains cable becomes damaged, replace it immediately with special cable obtained from service centre.
8. It's especially important to equip the socket or system with an efficient earth connection. The manufacturer declines the responsibility if the indication is not respected.

BATTERY IGNITION FOR THE STOVE PLS INSTALL THE BATTERY FIRST TO THE BATTERY BOX WHICH IS IN THE SOLEPLATE OF THE HOB

NOTE: 1. make sure the electrode is correct.
2. replace with new battery every half year.

The switch of the gas

When the switch of the gas is out of normal work, please ask for relevant service department.

Switch of the nozzles

Adjust suit nozzles corresponding to gas, while switch nozzles, please look "TECHNICAL DATA"

Switch of the nozzles

1. Move support, burner cup and burner lid;
2. Use sleeve wrench, switch suit nozzle in place of J (Figure 6)

Adjust low fire

1. Ignite burner, and turn the knob to low fire place
2. Take down knob (take down extended pole while the hob has it), use screwdriver to rounded bolt (Figure 7), fire became low while turn to clockwise, and fire became high while turn to anticlockwise

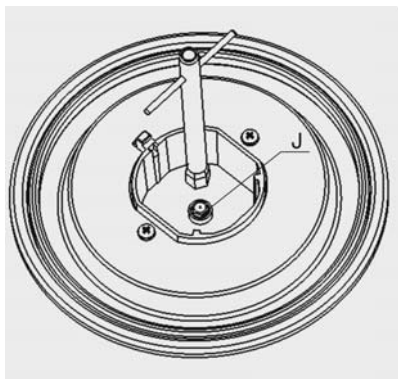

Figure 6

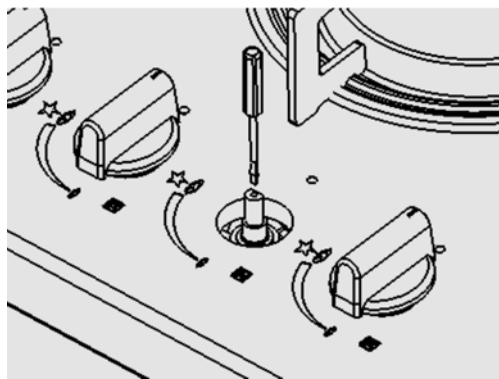

Figure 7

ELECTRIC CONNECTION FOR THE ELECTRIC IGNITION STOVE

1. The installation of the hob must be carried out according to the manufacturer's installing instructions, otherwise, the manufacturer declines any responsibility for damage resulting from failure to comply with this indication.
2. Electric connections must be carried out by a qualified technician.
3. Before plugging the hob into the mains, check that the voltage indicated on the data plate correspond to that of the electrical mains system and load of the cable.
4. When connecting the hob directly to the mains, install an omnipolar circuit-break with minimum contact opening of 3mm between the hob and the mains.
5. The supply cable should be positioned far away from hot objects so that it does not reach a temperature of more than 50°C with respect to the room temperature.

INSTRUCTIONS FOR USERS

Warning

The use of a gas cooking appliance results in the production of heat and moisture in the room in which it is installed. Ensure that the kitchen is well ventilated: keep natural ventilation holes open or install a mechanical ventilation device (mechanical extractor hood).

Prolonged intensive use of the appliance may call for additional ventilation, for example opening of a window, or more effective ventilation, for example increasing the level of mechanical ventilation where present.

The pressure can not be adjusted.

When cooking is finished, make sure to cut off the gas supply before your leave and sleep.

How to use the hob

--- Each burner is controlled by a corresponding gas control knob which controls the open and close of gas valve. The burner can be regulated with the corresponding control knob by using one of the following settings.

" ● " OFF 🔥 MAXIMUM 🔥 " MINIMUM

IGNITION

- 1) Press and rotate the corresponding knob in an anti-clockwise manner until the maximum position has coincided with the marker. After ignition, do not release the knob until the safety valve is open in 5-10 seconds. If the manual ignition is required, use an external flame to light the corresponding burner.